

Tools Required

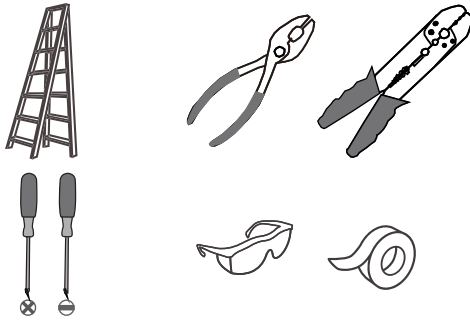

Light Source

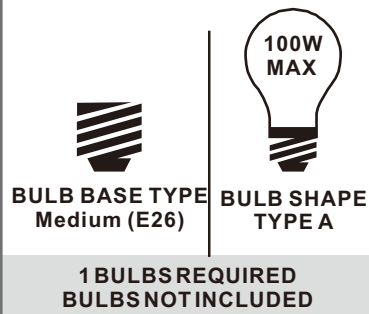

Fixture Height Adjustable 15.5" to 51.5"

Warnings and Cautions

Turn off the electricity at the circuit breaker before installation. Consult a licensed electrician if in doubt about installation.

Turn off power to the fixture and allow the bulbs to cool before replacing.

Package Contents

Preparation: Identify and inspect all parts before beginning the installation.

Missing or damaged parts? Contact your original place of purchase.

PARTS BAG

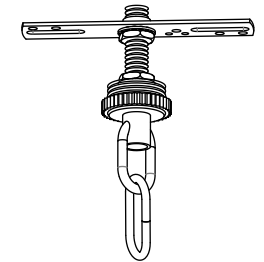

A Crossbar Assembly x 1



B Outlet Box Screw x 2



C Wire Connector x 3

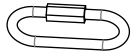

D Quick Link x 1



E Ceiling Canopy x 1



F Small Loop x 1



G 6" L Rod x 2



I 12" L Rod x 2



J Fixture Body x 1



H Shade x 1

Table of Contents

Rods & Small Loop Crossbar Assembly

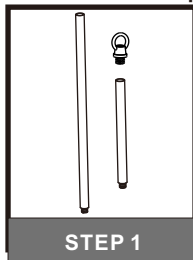

Quick Link

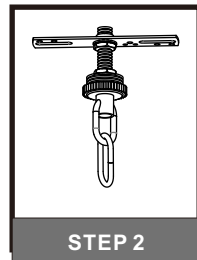

Wiring

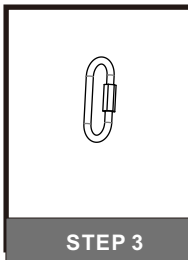

Ceiling Canopy

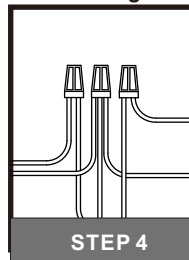

Bulb

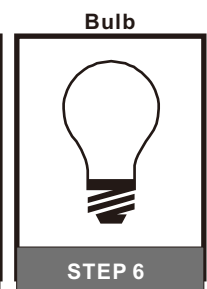
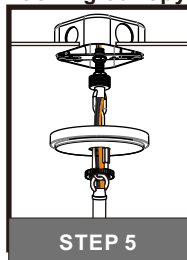

STEP 1

Optional Rods

8' ceiling:
(1) 6"L rods + (1) 12"L rods

9' ceiling:
(1) 6"L + (2) 12"L rods

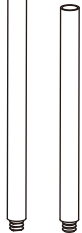

1 **2**

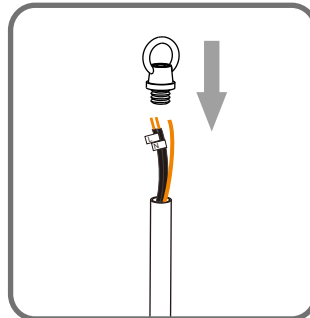
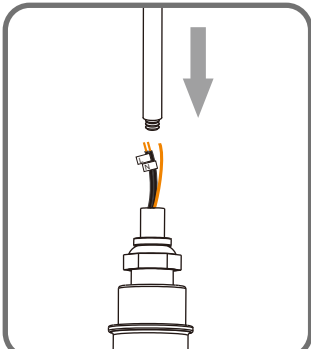

STEP 2

1 **2** **3**

Step 1
Install crossbar assembly

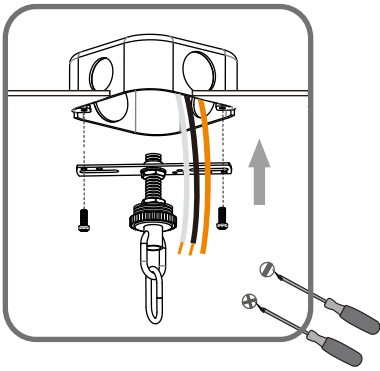

Step 2 - 3
Test fitting ceiling canopy to nipple

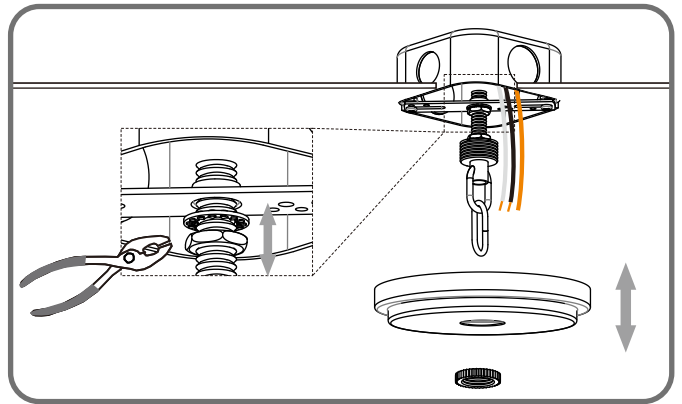
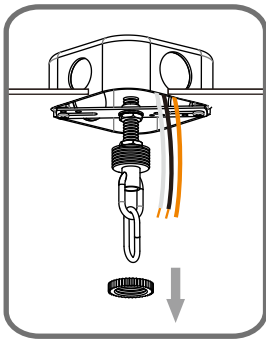

STEP 3

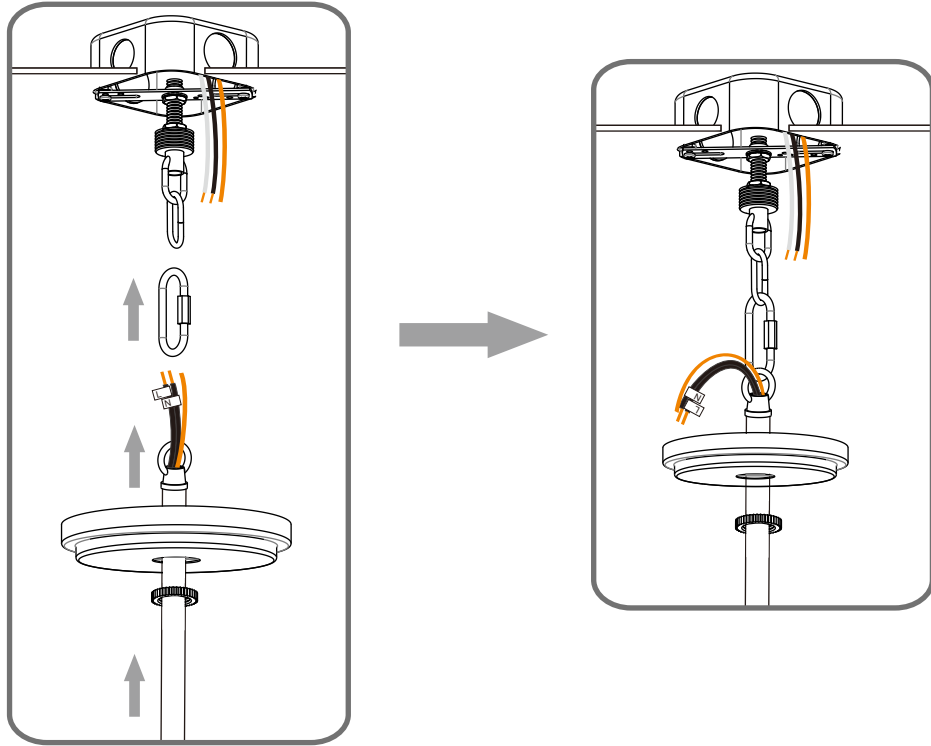

STEP 4

1

Step 1
Feed the fixture wires
through the loop

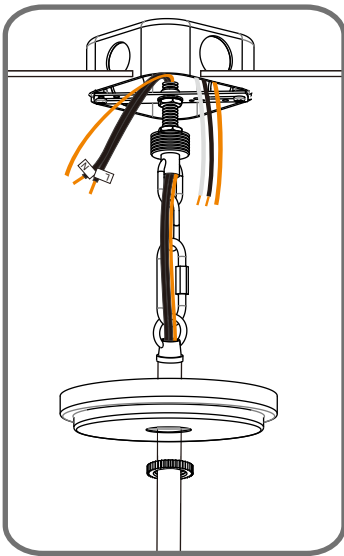

2

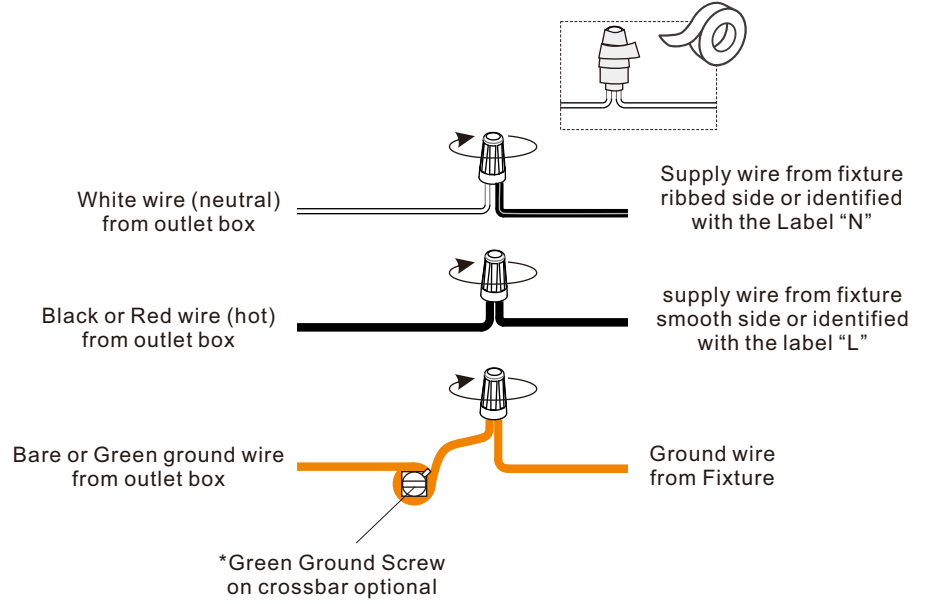

STEP 5

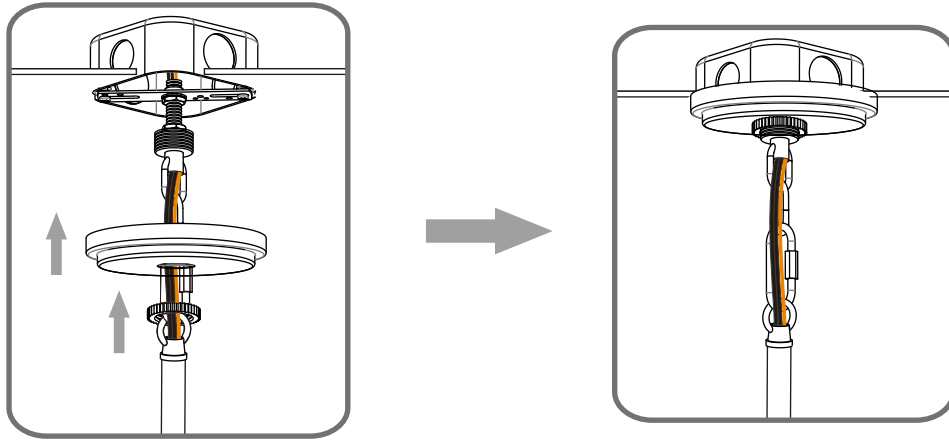

STEP 6

OPTION 1

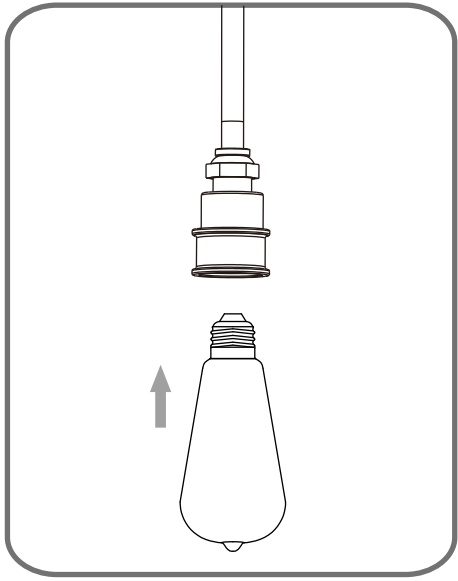

OPTION 2

